

## Forged steel flange gate valve

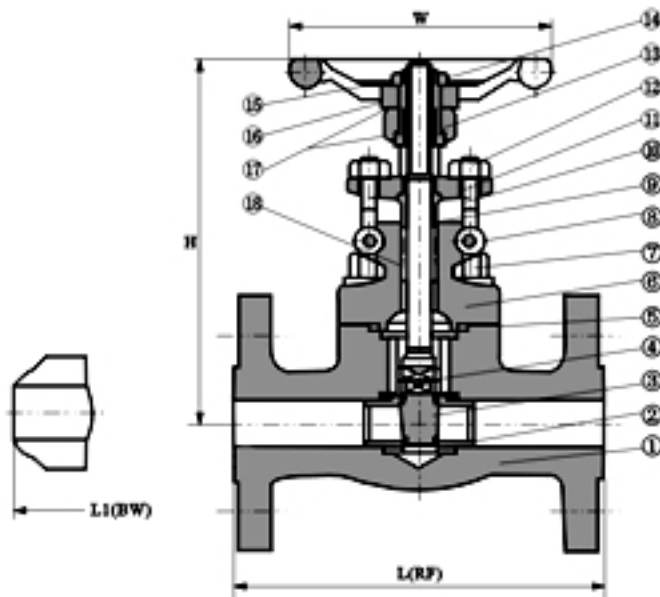

### Material List

Item	Part name	CS to ASTM	AS to ASTM	SS to ASTM	
		Type A105	Type F22	Type F304(L)	Type F316(L)
1	Body	A105	A182 F22	A182 F304(L)	A182 F316(L)
2	Seat	A276 420	A276 304	A276 304(L)	A276 316(L)
3	Wedge	A276 410 & 430	A182 F304	A182 F304(L)	A182 F316(L)
4	Stem	A182 F6	A182 F304	A182 F304(L)	A182 F316(L)

5	Gasket	SS+Flexible graphite		316+PTFE		
6	Bonnet	A105	A182 F22	A182 F304(L)	A182 F316(L)	
7	Bolt	A193 B7	A193 B16	A193 B8	A193 B8M	
8	Pin	A276 420		A276 304		
9	Gland	A276 410		A182 F304(L)	A182 F316(L)	
10	Gland eyebolt	A193 B7	A193 B16	A193 B8	A193 B8M	
11	Gland flange	A105	A182 F11	A182 F304(L)	A182 F316(L)	
12	Nut	A194 2H	A194 4	A194 8	A194 8M	
13	Yoke Nut	A276 410				
14	Lock Nut	A194 2H	A194 4	A194 8	A194 8M	
15	Nameplate	SS				
16	Handwheel	A197				
17	Bearing gasket	A473 431				
18	Packing	Flexible Graphite		PTFE		
Suitable medium		W.O.G etc		W.O.G etc	Nitric acid,Acetic acid etc.	
Suitable temperature		-29°C~425°C		-29°C~550°C	-29°C~180°C	
Note:Other material are available upon request.						
CS=Carbon steel; AS=Alloy steel; SS=Stainless steel;						
Size(MM)&Weight(KG)						
NPS 1/2" 3/4" 1" 1 1/4" 1 1/2" 2"						
L(RF)	150Lb		108	117	127	140
L1(BW)	300Lb		140	152	165	178
	600Lb		165	190	216	229
H	150Lb~300Lb		158	169	197	236
	600Lb		169	197	236	246
W			100	100	125	160
Weight	150Lb	RTJ	4.5	5.2	8.2	11.5
		BW	2.8	3.3	5.4	7.1
	300Lb	RTJ	4.8	6.2	9.3	14
		BW	3.5	4.4	6.8	8.1
	600Lb	RTJ	5.9	7.4	10.4	16.2
		BW	4.5	5.1	8.2	10.5

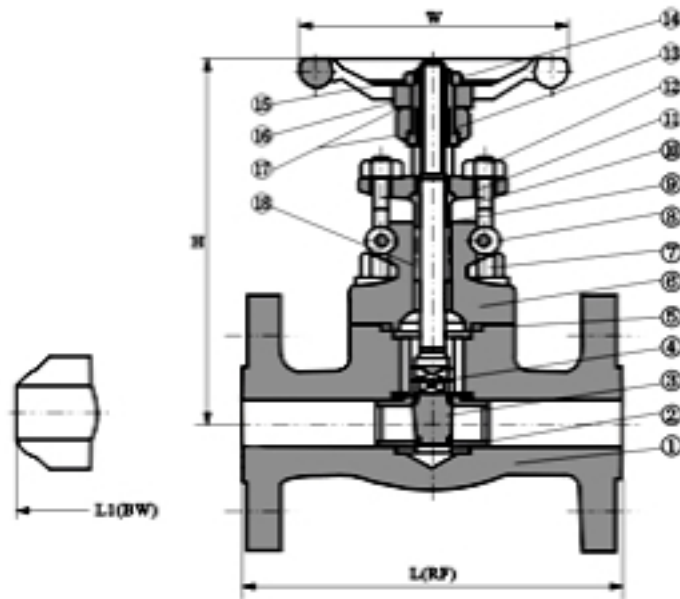

Forged steel flange gate valve 900Lb~1500Lb Material List

Item	Part name	CS to ASTM	AS to ASTM	SS to ASTM	
		Type A105	Type F22	Type F304(L)	Type F316(L)
1	Body	A105	A182 F22	A182 F304(L)	A182 F316(L)
2	Seat	A276 420	A276 304	A276 304(L)	A276 316(L)
3	Wedge	A276 410 & 430	A182 F304	A182 F304(L)	A182 F316(L)
4	Stem	A182 F6	A182 F304	A182 F304(L)	A182 F316(L)
5	Gasket	SS+graphite		SS+PTFE	
6	Bonnet	A105	A182 F22	A182 F304(L)	A182 F316(L)
7	Bolt	A193 B7	A193 B16	A193 B8	A193 B8M
8	Pin	A276 420		A276 304	
9	Gland	A276 410		A182 F304(L)	A182 F316(L)
10	Gland eyebolt	A193 B7	A193 B16	A193 B8	A193 B8M
11	Gland flange	A105	A182 F11	A182 F304(L)	A182 F316(L)
12	Nut	A194 2H	A194 4	A194 8	A194 8M
13	Yoke Nut	A276 420			
14	Lock nut	A194 2H	A194 4	A194 8	A194 8M
15	Nameplate	SS			
16	Hanwheel	A197			
17	Bearing gasket	A473 431			
18	Packing	Flexible Graphite		PTFE	
Suitable medium		W.O.G etc		W.O.G etc	Nitric acid,Acetic acid etc
Suitable temperature		-29℃~425℃		-29℃~550℃	-29℃~180℃

Note: Other materials are available upon request.

CS=Carbon steel; AS=Alloy steel; SS=Stainless steel;

Size(mm)&Weight(kg)

NPS		1/2"	3/4"	1"	1 1/2"	1 1/4"
L(RTJ)	900Lb ~	216	229	254	279	305
	1500Lb					
L1(BW)	900Lb ~	216	229	254	279	305
	1500Lb					
H(Open)		197	197	236	246	283
W		125	125	160	160	180
Weight	RTJ	7.2	11.5	15.6	16.2	22.6
	BW	5.2	9.3	12.4	13.8	18.9